

Air Purifier

Operating Instructions

**IDEAL AP30 PRO**



**IDEAL AP40 PRO**



## Table of Contents

---

<b>Intended use</b>	<b>3</b>
<b>Important safety instructions</b>	<b>3</b>
<b>Product features</b>	<b>5</b>
<b>Included in the box</b>	<b>5</b>
<b>Unpacking and setting up</b>	<b>6</b>
<b>Operation Startup / Fan speeds</b>	<b>8</b>
<b>Operation Display</b>	<b>9</b>
<b>Air quality indicator</b>	<b>9</b>
<b>Filter replacement indicator</b>	<b>9</b>
<b>only IDEAL AP40 PRO:</b>	
<b>Remote control (when using for the first time)</b>	<b>10</b>
<b>Remote control (replacing the battery)</b>	<b>11</b>
<b>Remote control (function)</b>	<b>12</b>
<b>Changing the filter</b>	<b>13</b>
<b>App Control</b>	<b>15</b>
<b>WLAN</b>	<b>15</b>
<b>Cleaning and maintenance</b>	<b>16</b>
<b>Accessories</b>	<b>16</b>
<b>Troubleshooting</b>	<b>17</b>
<b>Technical data</b>	<b>20</b>

## Important safety instructions

---



### Introduction

Thank you for choosing a device from IDEAL.

### Intended use

- The device is used exclusively for cleaning the ambient air indoors.
  - Please read these operating instructions before starting to use the device and please follow the safety instructions.  
The operating instructions must be kept available with the device at all times.
- 



### Important safety instructions

Read and save these instructions:

- Please follow the safety instructions to prevent fire, electric shock and injury to persons associated with use of the appliance.
- Only use the device indoors.
- Only use a wall socket that supplies the correct voltage (see rating plate).
- Do not modify or repair the device.
- Do not use the device if the power cable or mains plug is damaged or if the connection at the wall socket is not stable.
- Make sure that the power cable does not get crushed while you are using the device and that it cannot be damaged in any other way. Place the cable so that no one will trip over it. Do not place the power cable under strain.
- Disconnect the plug from the wall socket for cleaning purposes, before servicing and whenever the device is not in use for a significant period of time.
- Do not touch the plug or the device if you have wet hands.
- Keep packing material, such as plastic wrapping, away from children! (Risk of suffocation)
- Place the device at least 10 cm away from the wall.
- Keep the device away from areas subjected to draft (wind).
- Make sure that furniture, fabrics or other objects do not come in contact with the air intake/outlet or block them.
- Place the device on a stable, even surface and make sure there is sufficient air circulation.
- Do not spray any insect repellent.
- Do not use in rooms where the device may come into contact with fuel vapour or metal dust.
- Do not use any volatile liquids, petroleum, kerosene, paint thinner or polishing paste to clean the device. Such liquids may damage the surface of the device.
- Do not expose the device to rain, water, moisture or high humidity, and do not set it up in a bathroom or kitchen next to a sink.
- Make sure that no foreign objects get into the outlet grilles.
- Do not use near an open fire or sparks.
- The device is not suitable for removing harmful gases (carbon monoxide, e.g. from heating appliances).
- The appliance is not to be used by persons (including children) with reduced physical, sensory or mental capabilities, or lack of experience and knowledge, unless they have been given supervision or instruction.

## Important safety instructions

---



### Important safety instructions

- Children being supervised not to play with the appliance.
- Do not block the air intake and outlet.
- Keep this air purifier away from direct sunlight, naked flames or heat.
- Only use the air purifier in closed interiors and within the specified technical parameters. Improper usage may pose a threat to life and health.
- Do not use the unit near a fire alarm. If the outlet air is blowing towards a fire alarm, the alarm may respond late or not at all.
- Disconnect the mains plug prior to any cleaning or maintenance work.
- Replace the filter cartridge as soon as the filter replacement indicator lights up. The average life expectancy of the filter is approx. 1 year (depending on operation and purification activities).
- Clean the air purifier housing with a lint-free cloth moistened with soapy water.
- Clean the filter cartridge's pre-filter with a vacuum cleaner.
- Do not use any solvents. These could damage the housing surface.
- Protect the air purifier from water.
- Do not use any substances containing silicone, since this could destroy the air quality sensor.
- Do not test the effectiveness of the air quality sensor with high quantities of gas, or alcohol, since this could destroy the air quality sensor.
- Clean the textile cover with a vacuum cleaner.
- If necessary, the textile cover can also be washed by hand (please refer to the care instructions on the label).
- WARNING: Chemical Burn Hazard. Keep batteries away from children.
- This product contains a lithium button/coin cell battery. If a new or used lithium button/coin cell battery is swallowed or enters the body, it can cause severe internal burns and can lead to death in as little as 2 hours. Always completely secure the battery compartment. If the battery compartment does not close securely, stop using the product, remove the batteries, and keep it away from children. If you think batteries might have been swallowed or placed inside any part of the body, seek immediate medical attention.



### Caution

Risk of injury due to electric shock.

Always disconnect the mains plug prior to:

- Carrying out maintenance work or cleaning
- Moving the device
- Changing the filter



### Danger

- Do not use any spray cans with flammable content near to the Air Purifier!



### Danger

- Do not use any flammable cleaning agents.

## Product features / Included in the box

---

### Product features

- **Filter replacement indicator:**  
The air purifier indicates that the filter cartridge needs to be changed via a switch button (EASY touch) which flashes orange.
  - **Air purification in 5 speed settings**
  - **3-stage air purification system:**  
Pre-filter, HEPA filter coated with activated carbon
  - **360° filter (Pre-filter, HEPA + active carbon)**  
Easy maintenance and replacement of the filter cartridge.
- 

### Included in the box

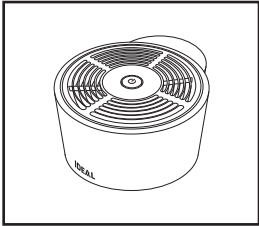

**Air Purifier  
(Unit head)**

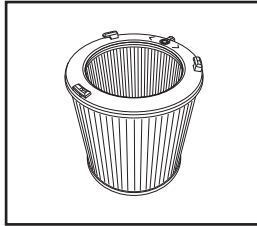

**Filter cartridge**

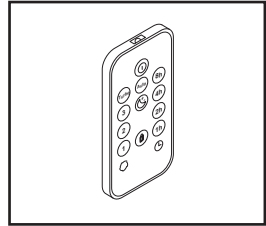

**Remote control**  
• With 3V lithium battery  
(only IDEAL AP40 PRO)

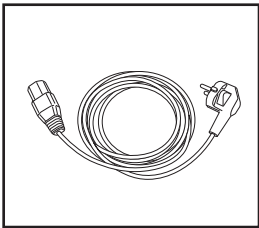

**Power cable**

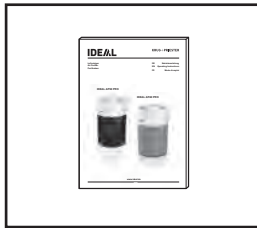

**Printed operating  
instructions**

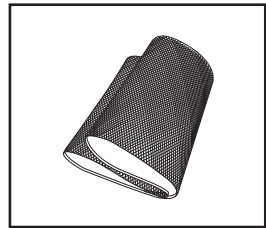

**Premium textile cover**  
• with Velcro fastener  
(only IDEAL AP40 PRO)

## Unpacking and setting up

---

### Installation guidelines for optimum performance:

- Place the device at least 10 cm away from the wall.
- Keep the device away from areas subjected to draft (wind).
- Make sure that furniture, fabrics or other objects do not come in contact with the air intake/outlet or block them.
- Place the device on a stable, even surface and make sure there is sufficient air circulation.

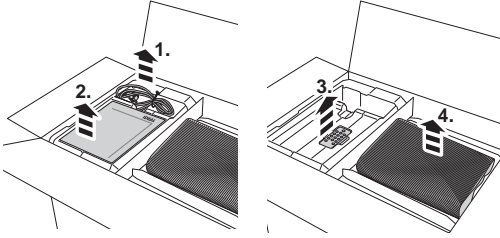

Remove power cable (1.), operating instructions (2.), remote control (3. only IDEAL AP40 PRO) and textile cover (4. only IDEAL AP40 PRO).

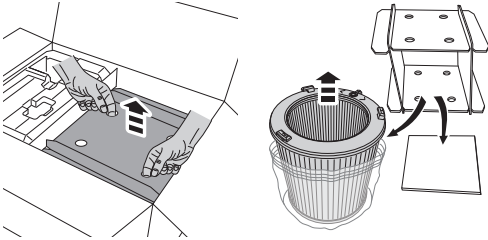

Lift the filter cartridge out of the box, unpack it and remove the protective film.

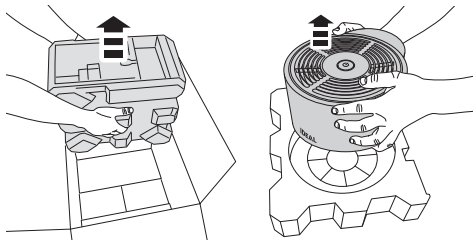

Remove the air purifier (unit head) and unpack.

## Unpacking and setting up

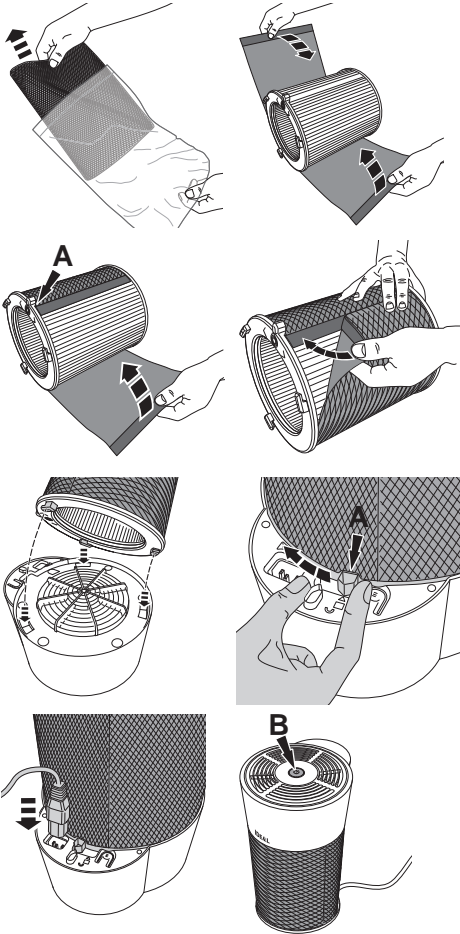

Take the textile cover (only IDEAL AP40 PRO) out of the protective film, place it around the filter cartridge and close it at the back (locking component **A**).

Insert the filter cartridge with the three snap-fit tabs into the three recesses provided for this and lock it at the locking component (**A**).

Connect the power cable to the device first, then to the socket.

If the filter cartridge is missing or not installed correctly, the switch button (**B**) flashes red and the air purifier will not work.

**Note:**  
Use the original packaging to store the air purifier if you are not using it all year round. Pack and store the filter cartridge airtight to protect the activated carbon.

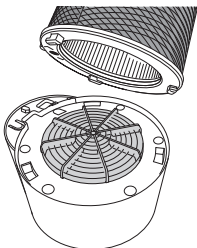

### ⚠ Safety information

No operation of the air purifier without the complete and secure attachment of the cladding and safety covers (Motor protection grille, filter cartridge, etc.).

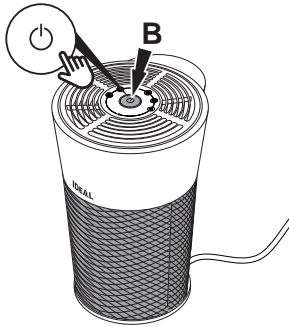

### Startup / Fan speeds

1. Plug in the power cable, press the switch button (B). The air purifier starts in automatic mode (🌀). The switch button lights up.
2. Press the switch button to exit automatic mode. The air purifier now runs at fan speed 1 (🌀). The switch button flashes once.
3. Press again to increase the fan speed to 2 (🌀). The switch button flashes twice. Press again to increase the fan speed to 3 (🌀) (flashes 3 times) or to the turbofan speed T (🌀) (flashes 4 times).
4. If you press the switch button again, the air purifier switches to the Quiet function (🌀). The switch button lights up, but only dimly.  
→ The Quiet function is provided for particularly low-noise, unobtrusive operation (e.g. bedrooms). The air purifier switches to the lowest fan speed.
5. When the switch button is pressed again, the air purifier returns to automatic mode (🌀).

#### Note:

The air purifier can be switched off by pressing and holding down the switch button. Just press it to switch the device back on.



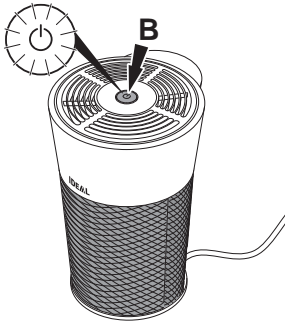

### Display

#### Air quality indicator

The air quality is displayed in 3 colours (in all fan speeds):

Switch button (B) green:	good air quality
Switch button yellow:	average air quality
Switch button red:	poor air quality

#### Filter replacement indicator

The switch button (B) flashes orange to indicate that the filter needs changing (flashes at intervals).

- The life expectancy of the filter is approx. 1 year (depending on operation and purification activities).
- If odours are no longer being filtered out, or if the filter produces unpleasant odours, then the filter cartridge needs to be replaced sooner.
- Only use original IDEAL filter cartridge. The device will only function with an original IDEAL filter cartridge.

#### Note:

If the filter cartridge is missing or not installed correctly, the switch button flashes red and the air purifier will not work.

## Remote control (only IDEAL AP40 PRO)

---

### Battery usage

- Always use 3V lithium batteries CR2025 for the remote control.
- Incorrect battery usage may result in leakage of battery fluid and/or damage.
- If the remote control is not going to be used for a long time, please remove the battery.

### Unsuitable location

- Make sure that no objects or furnishings are situated between the remote control and the air purifier.
- The air purifier should not be placed in direct sunlight. This could impair the infrared sensor.
- Locations where fluorescent tubes are flickering because they are defective or old.
- Do not store the remote control in direct sunlight and/or close to radiators/heaters.

### When using for the first time

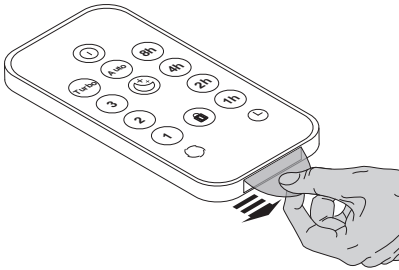

The remote control has a pre-installed lithium battery CR2025. **Remove the protective flap** to activate the remote control battery.

---

### How to use correctly

- Point the remote control at the air purifier (switch button **B**).

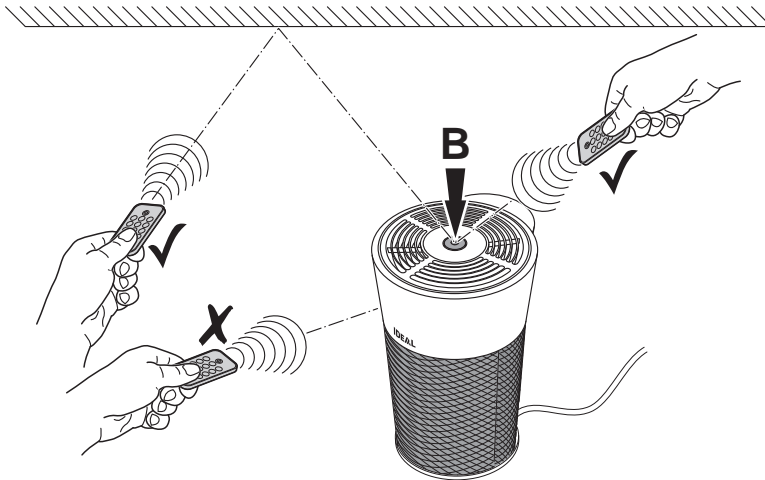

## Remote control (only IDEAL AP40 PRO)

---

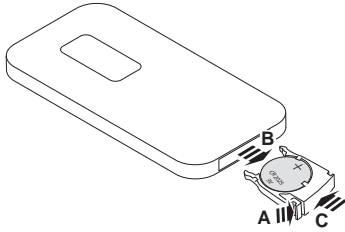

### Replacing the battery

- Open the battery compartment by pressing (A) and pulling out (B) at the same time. Take out the flat battery.
- Insert a new battery into the battery compartment, making sure the polarity is correct (+ / -).
- Always use 3V lithium batteries CR2025.
- Slide the battery compartment back into its seating (C).

### Important information about the batteries and how to dispose of them





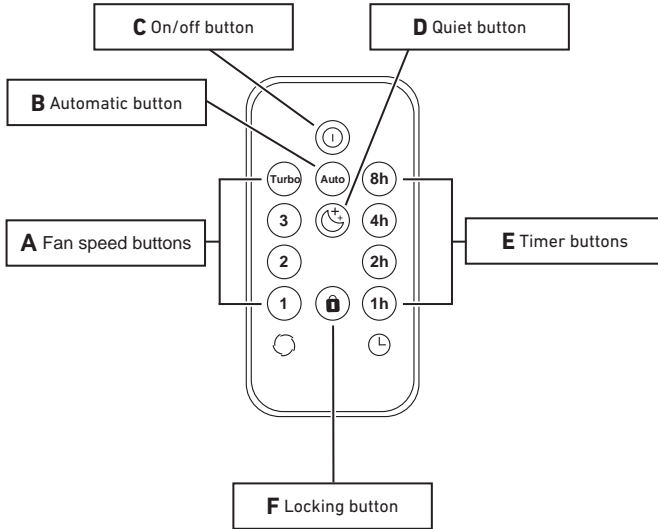

Batteries must NOT be disposed of with household waste. As the user, you are legally obligated to return used batteries for proper disposal. You can hand in your batteries at public collection points in your community or wherever the same type of batteries are sold.

- It is very important that you make sure that the polarity of the batteries is correct. Wrongly inserted batteries could destroy the device – a fire hazard.
- Do not try to open or damage batteries and do not throw batteries into a fire.
- Batteries that are leaking fluid are dangerous. Only touch these with suitable gloves.
- Keep batteries out of the reach of children.
- Take the batteries out of the device if you are not going to be using it for a significant period of time.
- The cells shall be disposed of properly, including keeping them away from children.
- Even used cells may cause injury.

## Remote control (only IDEAL AP40 PRO)



### Function

- A:** Select the required fan speed .
- B:** Switches the air purifier to automatic mode .
- C:** Switches the air purifier on/off .
- D:** Switches the air purifier to Quiet mode .
- E:** Select the required timer time .
- Pressing the timer while the air purifier is switched on activates the "switch-off timer"  
→ after the set time, the air purifier switches off.  
Pressing the timer button while the air purifier is switched off activates the "switch-on timer"  
→ after the set time, the air purifier switches on.  
Visualisation only in the app (smartphone / tablet).
- F:** Press the locking button  to lock the air purifier switch button. Press the locking button again to unlock.  
It can also be unlocked by disconnecting the air purifier from the mains.

### Note:

When the remote control is operated, the switch button on the air purifier lights up white for approx. 1 second in acknowledgement. If you press the air purifier switch button when the locking function is activated, it lights up briefly in red.

## Filter replacement

Filter replacement (e.g. in accordance with the filter replacement indicator)

### Note:

Only original IDEAL filter cartridges (order from [www.mbmcorp.com](http://www.mbmcorp.com)) may be used. No tools are required to replace the filter cartridge.

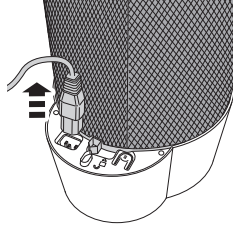
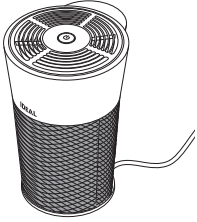

### CAUTION!

Take the mains plug out of the socket.

Turn the air purifier upside down. Pull the mains plug out of the device.

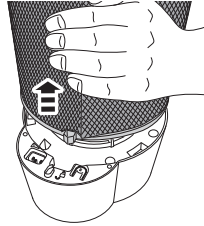
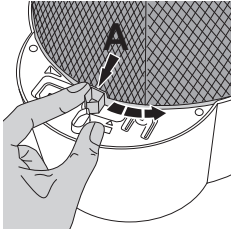

Unlock the filter cartridge at the locking component (A)  and remove.

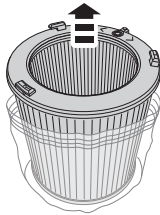
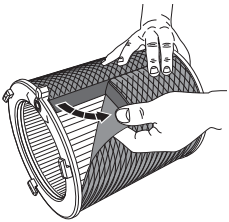

Remove the textile cover (only IDEAL AP40 PRO).

Remove the protective film from the new filter cartridge.

## Filter replacement

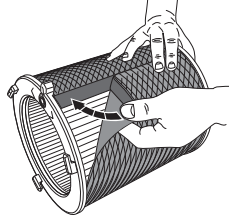
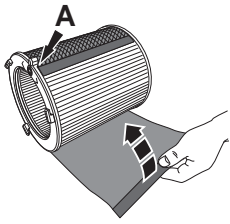

Put the textile cover (only IDEAL AP40 PRO) back on the filter cartridge and close it at the back (locking component **A**).

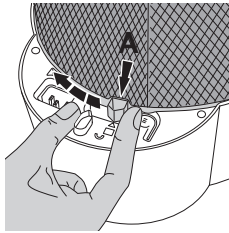
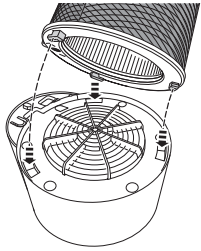

Insert the filter cartridge with the three snap-fit tabs into the three recesses provided for this and lock it at the locking component (**A**).

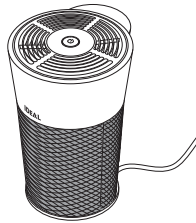
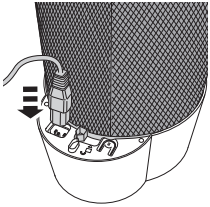

Connect the power cable to the device first, then to the socket. The device will only work if the filter cartridge is installed correctly.

### Note:

The air purifier automatically detects that a new IDEAL filter cartridge has been inserted and automatically resets the filter replacement indicator.

IDEAL filter cartridge

Order no. AC1011

## App Control / WLAN

---

### App Control

Your purifier can additionally be controlled by the "IDEALAIRPRO" App via your smartphone / tablet (iOS /Android).



---

### WLAN

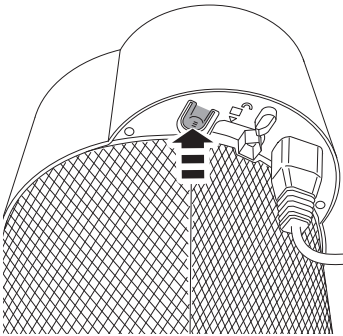

#### Querying the WLAN status:

The air purifier is switched on.

Press the WLAN button

→ the WLAN is enabled when the switch button flashes blue

→ the WLAN is disabled when the switch button flashes white.

#### Enabling/disabling WLAN

The air purifier is switched on.

Press the WLAN button and while the switch button is flashing (blue or white), press the WLAN button again to enable or disable the WLAN.

#### Resetting the WLAN:

The air purifier is switched on. WLAN is enabled.

Press and hold down the switch button and the WLAN button at the same time until the switch button flashes pink.

## Cleaning and maintenance / Accessories

---

### Cleaning and maintenance

 **CAUTION: Disconnect the mains plug prior to any cleaning or maintenance work!**

- Replace the filter cartridge as soon as the filter replacement indicator lights up. The average life expectancy of the filter is approx. 1 year (depending on operation and purification activities).
  - Clean the air purifier housing with a lint-free cloth moistened with soapy water.
  - Clean the filter cartridge's pre-filter with a vacuum cleaner.
  - Do not use any solvents. These could damage the housing surface.
  - Protect the air purifier from water.
  - Do not use any substances containing silicone, since this could destroy the air quality sensor.
  - Do not test the effectiveness of the air quality sensor with high quantities of gas, or alcohol, since this could destroy the air quality sensor.
  - Clean the textile cover with a vacuum cleaner.
  - If necessary, the textile cover can also be washed by hand (please refer to the care instructions on the label).
- 

### Accessories

You can source accessories via your dealer or at [www.mbmcorp.com](http://www.mbmcorp.com).

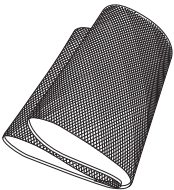

Premium textile cover

Order no. AC1028

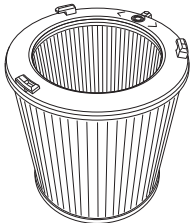

IDEAL filter cartridge

Order no. AC1011

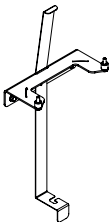

Wall mount

Order no. AC1025



## Troubleshooting

<p><b>The air purifier won't switch on.</b></p>          <p><b>The switch button flashes red and the air purifier doesn't work.</b></p>	<p><b>Is the power cable securely connected to the back of the device?</b></p> <ul style="list-style-type: none"><li>→ Make sure that the power cable is not damaged in any way</li><li>→ Check both ends of the power cable. Make sure that these are plugged in and that the purifier is connected to the power supply.</li></ul> <p><b>Is an original IDEAL filter cartridge installed? Is the filter cartridge also inserted correctly?</b></p> <ul style="list-style-type: none"><li>→ Make sure that an original IDEAL filter cartridge is inserted.</li><li>→ Make sure that the filter cartridge is clicked in place with all 3 tabs and is fully locked.</li></ul>
<p><b>The switch button on the air purifier is not working.</b></p>          <p><b>The buttons on the remote control do not work. (only IDEAL AP40 PRO).</b></p>	<p><b>Has the locking function been activated?</b></p> <ul style="list-style-type: none"><li>→ Disable the locking function on the remote control (only IDEAL AP40 PRO) or via the app (Function F).</li><li>→ Unplug the power cable and then plug it back in.</li></ul> <p><b>Is the battery in the remote control? Or is it flat?</b></p> <ul style="list-style-type: none"><li>→ Check the battery (3V lithium CR2025).</li></ul> <p><b>Are you using it correctly?</b></p> <ul style="list-style-type: none"><li>→ Point the remote control at the air purifier</li><li>→ Having joined the power cord or exchanged the filter, the function of the remote control is blocked for about 10 seconds.</li></ul>

## Troubleshooting

<p><b>The switch button is lit up only dimly or not lit up at all.</b></p>	<p><b>Is the air purifier switched on?</b></p> <p>→ Switch on the air purifier by pressing the switch button.</p> <p><b>Has the Quiet function been activated?</b></p> <p>→ If you press the switch button once, the air purifier switches to automatic mode.</p> <p>→ Disable the Quiet function by selecting a different fan speed via the app or on the remote control (only IDEAL AP40 PRO).</p>
<p><b>Automatic mode is not working properly.</b></p>	<p><b>The air purifier is calibrating the air quality sensor. This happens when you first switch it on and after disconnecting it from the mains.</b></p> <p>→ Wait until the calibration process has been completed (this may take a few minutes)</p> <p><b>The air quality sensor is not detecting the air quality reliably.</b></p> <p>→ Calibrate the air quality sensor by briefly disconnecting it from the mains again!</p>
<p><b>Odours are not being filtered properly.</b></p>	<p><b>Is the air purifier continuously exposed to strong odours?</b></p> <p>→ The filter needs to be changed because the activated carbon filter becomes saturated and reliable air purification is no longer guaranteed.</p> <p><b>Are the odours being drawn in at all?</b></p> <p>→ Place the air purifier closer to the source of the odours.</p> <p>→ Switch the air purifier manually to a higher fan speed.</p>

## Troubleshooting

---

**The air purifier is making loud noises.**

**Is the filter cartridge really dirty?**

→ Clean the pre-filter with a vacuum cleaner.

**Is the air purifier located on an even surface?**

→ Place the device on an even surface.

**Is the air purifier running at a high fan speed?**

→ Use the switch button to set a lower fan speed.

---

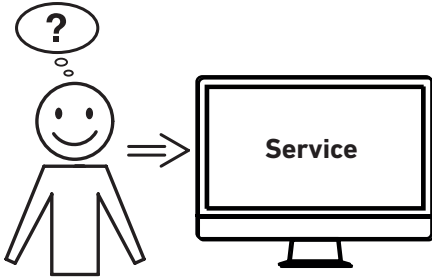



**Did none of the specified solutions help you with your problem?**

- Contact: Service
- [www.mbmcorp.com](http://www.mbmcorp.com)
  - 843-552-2700



## Technical data

---

### **IDEAL AP30 PRO:**

Power supply	200-240V-50/60Hz / 100-120V-50/60Hz
Power consumption	30W (200-240V) / 25W (100-120V)
Suitable for rooms	20 to 40 m <sup>2</sup> *
Air flow rate (max.)	310 m <sup>3</sup> /h
Dimensions (L × W × H)	298 × 255 × 398 mm
Weight	3,6 kg
Volume at turbofan speed  (max.)	54,2 dB(A)
Volume in Quiet mode  (min.)	16,7 dB(A)

### **IDEAL AP40 PRO:**

Power supply	200-240V-50/60Hz / 100-120V-50/60Hz
Power consumption	75W (200-240V) / 55W (100-120V)
Suitable for rooms	30 to 50 m <sup>2</sup> *
Air flow rate (max.)	440 m <sup>3</sup> /h
Dimensions (L × W × H)	298 × 255 × 398 mm
Weight	3,6 kg
Volume at turbofan speed  (max.)	61,7 dB(A)
Volume in Quiet mode  (min.)	16,7 dB(A)

Subject to technical changes.

\* For a room height of 2.50 m



The company Krug + Priester has the following certifications:

- Quality management system according to DIN EN ISO 9001:2015
- Environmental management system according to DIN EN ISO 14001:2015
- Energy management system according to DIN EN ISO 50001:2018

## Storage

We recommend storing the air purifier in its original packaging in a cool, dry place. Pack and store the filter cartridge airtight to protect the activated carbon.

## Spare parts and accessories

You can source spare parts via your dealer or at [www.mbmcorp.com](http://www.mbmcorp.com). Only use the manufacturer's original parts.

## Repairs

Repairs must only be carried out by qualified experts or the customer service department. This also applies if you have a defective power cable. Any attempt by untrained persons to perform repairs may pose considerable risk to the user and invalidate the warranty.

## Disposal

This device must not be disposed of with household waste! Please hand this device in at the collection points provided! Collecting and recycling electrical and electronic waste conserves valuable resources! The packaging material can be recycled. Dispose of the packaging in an environmentally friendly manner and take it to the recyclable waste collection.

**Thanks!**





This machine is GS-tested and conforms to the following EC guidelines:

- 2014/35/EU for electrical safety
- 2014/30/EU for electromagnetic compatibility.
- 2011/65/EU, 2015/863/EU RoHS.

For specific technical data, please refer to the information on the identification plate of the machine.

To file a warranty claim, the device must still bear its original identification plate.

Subject to technical changes.



### EC-declaration of conformity

- Herewith we declare that



**LISTED**

AIR FILTER E521191



	<b>GS-IDENT. No.</b>	<b>UL-IDENT. No.</b>
<b>IDEAL AP30 PRO</b> Made in Germany	<b>11731002</b>	<b>10731002</b>
<b>IDEAL AP40 PRO</b> Made in Germany	<b>11731001</b>	<b>10731001</b>

- complies with the following provisions applying to it

**2014/35/EU**  
Low voltage directive

**2011/65/EU, 2015/863/EU**  
RoHS directive

**2014/30/EG**  
EMV Electromagnetic compatibility directive

- Applied harmonised standards in particular

**IEC 61000-3-2; IEC 61000-3-3; EN 61000-3-2; EN 61000-3-3;  
EN 60335-2-65; EN 60335-1;  
EN ISO 13857; EN 55014-1; EN 55014-2;  
BS EN 55014-1; BS EN 55014-2 ;  
BS EN 61000-3-2; BS EN 61000-3-3;  
BS EN 60335-2-65; BS EN 60335-1; BS EN ISO 13857-1**

09.02.2022  
Date

Authorized representative for technical documentation:

- Managing Director -

Krug & Priester GmbH & Co. KG  
Simon-Schweitzer-Str. 34  
D-72336 Balingen (Germany)



## Supplier's Declaration of Conformity 47 CFR § 2.1077 Compliance Information

This device complies with part 15 of the FCC Rules. Operation is subject to the following two conditions:

- (1) This device may not cause harmful interference, and
- (2) this device must accept any interference received, including interference that may cause undesired operation.

**Manufacturer:** KRUG + PRIESTER GMBH & CO KG  
Simon-Schweitzer-Straße 34  
72336 Balingen, Germany

**U.S. Responsible Party:** MBM Corporation  
3134 Industry Drive  
North Charleston SC, 29418  
Tel: 843-552-2700  
Mail: [info@mbmcorp.com](mailto:info@mbmcorp.com)

**Trade Name:** IDEAL

**Models:** AP 30/ 40/ 60/ 80/ 140 PRO

**Classification:** FCC Part 15B

We hereby declare, that the equipment bearing tradename and model number specified above was tested conforming to the applicable FCC rule part(s) 15B and the most accurate measurement standards. We confirm that the necessary steps have been taken and are in force to assure that the production units of the same equipment will continue to comply with the Commission's requirements.

Krug + Priester GmbH & Co KG

**NOTE:** This equipment has been tested and found to comply with the limits for a Class B digital device, pursuant to part 15 of the FCC Rules. These limits are designed to provide reasonable protection against harmful interference in a residential installation. This equipment generates, uses and can radiate radio frequency energy and, if not installed and used in accordance with the instructions, may cause harmful interference to radio communications. However, there is no guarantee that interference will not occur in a particular installation. If this equipment does cause harmful interference to radio or television reception, which can be determined by turning the equipment off and on, the user is encouraged to try to correct the interference by one or more of the following measures:

- Reorient or relocate the receiving antenna.
- Increase the separation between the equipment and receiver.
- Connect the equipment into an outlet on a circuit different from that to which the receiver is connected.
- Consult the dealer or an experienced radio/TV technician for help.

To ensure compliance with FCC and ISED RF exposure requirements this device must be installed to provide a minimum of 20cm between the device and people.

---

Notes :



## KRUG + PRIESTER

Krug & Priester GmbH & Co. KG  
Simon-Schweitzer-Str. 34  
D-72336 Balingen (Germany)