

## VRCut Controller Hardware Kit

Everything you need, right out of the box.

The VRCut Controller hardware kit contains all you need to use your VRCut Ready Triumph cutter to its full VRCut capabilities! Qualified VRCut Ready Triumph customers may request a kit shipped to their location at no cost, including shipping.

### What's in the Box

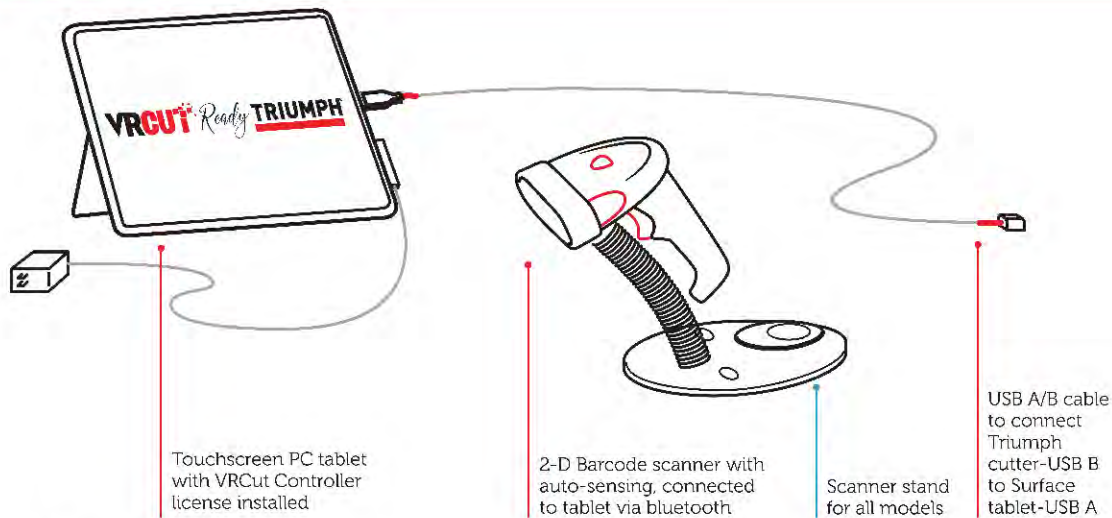

### Program Implementation

All customers who purchase a new VRCut Ready Triumph Cutter may request a VRCut Controller Hardware kit be shipped to their location at no charge (a \$699 value). Qualified customers can register their VRCut license at [lytrod.com/my-account](https://lytrod.com/my-account) and request the hardware kit. Kits can also be purchased from your MBM dealer or at [lytrod.com/store](https://lytrod.com/store). Contact your MBM dealer or Lytrod sales executive for more information.



VRCut Controller Hardware Kit comes as is and is not replaceable. Only new Triumph 5260, 5560, 6660 & 7260 cutters sold after April 1st, 2023 are qualified. Limit one kit per qualified Triumph Cutter. Free shipping limited to the United States and Canada. To request a kit, qualified customers must register their VRCut Software assigned to their VRCut Ready Triumph Cutter Machine Serial Number on the Lytrod.com customer web portal. The tablet comes installed with the VRCut Controller software assigned to the specified Triumph machine serial number. The tablet is configured to support the VRCut Controller software only; Windows PC admin rights are not granted to the vrcut user profile. To benefit from the complete VRCut software workflow, customers are encouraged to install VRCut Impose software on their pre-press/design PC. Visit [lytrod.com](https://lytrod.com) for additional products and services.

©2024 Lytrod Software, Inc. All rights reserved. Unauthorized duplication is a violation of applicable law. Lytrod Software, the Lytrod logo and the VRCut logo are registered trademarks of Lytrod Software, Inc. MBM logo is a registered trademark of MBM Corporation.