

## Quick start guide



# EN Intended use / Important safety instructions

## Intended use

The device is used exclusively for cleaning the ambient air indoors.



You will find detailed operating instructions at [www.mbmcorp.com](http://www.mbmcorp.com).



## Important safety instructions

Read and save these instructions:



- Please follow the safety instructions to prevent fire, electric shock and injury to persons associated with use of the appliance.
- Only use the device indoors.
- Only use a wall socket that supplies the correct voltage (see rating plate).
- Do not modify or repair the device.
- Do not use the device if the power cable or mains plug is damaged or if the connection at the wall socket is not stable.
- Make sure that the power cable does not get crushed while you are using the device and that it cannot be damaged in any other way. Place the cable so that no one will trip over it. Do not place the power cable under strain.
- Disconnect the plug from the wall socket for cleaning purposes, before servicing and whenever the device is not in use for a significant period of time.
- Do not touch the plug or the device if you have wet hands.
- Keep packing material, such as plastic wrapping, away from children! (Risk of suffocation)
- Place the device at least 10 cm away from the wall.
- Keep the device away from areas subjected to draft (wind).
- Make sure that furniture, fabrics or other objects do not come in contact with the air intake/outlet or block them.
- Place the device on a stable, even surface and make sure there is sufficient air circulation.
- Do not spray any insect repellent.
- Do not use in rooms where the device may come into contact with fuel vapour or metal dust.
- Do not use any volatile liquids, petroleum, kerosene, paint thinner or polishing paste to clean the device. Such liquids may damage the surface of the device.
- Do not expose the device to rain, water, moisture or high humidity, and do not set it up in a bathroom or kitchen next to a sink.
- Make sure that no foreign objects get into the outlet grilles.
- Do not use near an open fire or sparks.
- The device is not suitable for removing harmful gases (carbon monoxide, e.g. from heating appliances).
- The appliance is not to be used by persons (including children) with reduced physical, sensory or mental capabilities, or lack of experience and knowledge, unless they have been given supervision or instruction.
- Children being supervised not to play with the appliance.
- Do not block the air intake and outlet.
- Keep this air purifier away from direct sunlight, naked flames or heat.
- Only use the air purifier in closed interiors and within the specified technical parameters. Improper usage may pose a threat to life and health.
- Do not use the unit near a fire alarm. If the outlet air is blowing towards a fire alarm, the alarm may respond late or not at all.

# EN Important safety instructions



## Important safety instructions

- Disconnect the mains plug prior to any cleaning or maintenance work.
- Replace the filter cartridge as soon as the filter replacement indicator lights up. The average life expectancy of the filter is approx. 1 year (depending on operation and purification activities).
- Clean the air purifier housing with a lint-free cloth moistened with soapy water.
- Clean the filter cartridge's pre-filter with a vacuum cleaner.
- Do not use any solvents. These could damage the housing surface.
- Protect the air purifier from water.
- Do not use any substances containing silicone, since this could destroy the air quality sensor.
- Do not test the effectiveness of the air quality sensor with high quantities of gas, or alcohol, since this could destroy the air quality sensor.
- Clean the textile cover with a vacuum cleaner.
- If necessary, the textile cover can also be washed by hand (please refer to the care instructions on the label).
- **WARNING: Chemical Burn Hazard. Keep batteries away from children.**
- This product contains a lithium button/coin cell battery. If a new or used lithium button/coin cell battery is swallowed or enters the body, it can cause severe internal burns and can lead to death in as little as 2 hours. Always completely secure the battery compartment. If the battery compartment does not close securely, stop using the product, remove the batteries, and keep it away from children. If you think batteries might have been swallowed or placed inside any part of the body, seek immediate medical attention.

## Warning symbols

-  Risk of injury due to electric shock. Always disconnect the mains plug prior to:
  - Carrying out maintenance work or cleaning
  - Moving the device
  - Changing the filter
-  Do not use any spray cans with flammable content near to the Air Purifier!
-  Do not use any flammable cleaning agents.

## Important informations about batteries

 <b>WARNING</b>	
<ul style="list-style-type: none"><li>• <b>INGESTION HAZARD:</b> This product contains a button cell or coin battery.</li><li>• <b>DEATH</b> or serious injury can occur if ingested.</li><li>• A swallowed button cell or coin battery can cause <b>Internal Chemical Burns</b> in as little as <b>2 hours</b>.</li><li>• <b>KEEP</b> new and used batteries <b>OUT OF REACH</b> of <b>CHILDREN</b></li><li>• <b>Seek immediate medical attention</b> if a battery is suspected to be swallowed or inserted inside any part of the body.</li></ul>	

- Remove and immediately recycle or dispose of used batteries according to local regulations and keep away from children. Do NOT dispose of batteries in household trash or incinerate.
- Even used batteries may cause severe injury or death.
- Call a local poison control center for treatment information.
- Always use 3V lithium batteries CR2025.
- Non-rechargeable batteries are not to be recharged.
- Do not force discharge, recharge, disassemble, heat above (manufacturer's specified temperature rating) or incinerate. Doing so may result in injury due to venting, leakage or explosion resulting in chemical burns.
- Ensure the batteries are installed correctly according to polarity (+ and -).
- Do not mix old and new batteries, different brands or types of batteries, such as alkaline, carbon-zinc, or rechargeable batteries.
- Remove and immediately recycle or dispose of batteries from equipment not used for an extended period of time according to local regulations.
- Always completely secure the battery compartment. If the battery compartment does not close securely, stop using the product, remove the batteries, and keep them away from children.

# EN Setting up / Operation

## Setting up

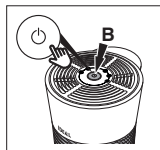
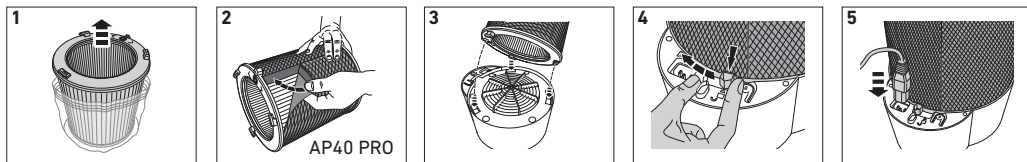

### Fan speed

1. Plug in the power cable, press the switch button (B). The air purifier starts in automatic mode (A). The switch button lights up.
  2. Press the switch button to exit automatic mode. The air purifier now runs at fan speed 1 (1). The switch button flashes once.
  3. Press again to increase the fan speed to 2 (2). The switch button flashes twice. Press again to increase the fan speed to 3 (3) (flashes 3 times) or to the turbofan speed T (T) (flashes 4 times).
  4. If you press the switch button again, the air purifier switches to the Quiet function (Q). The switch button lights up, but only dimly. → The Quiet function is provided for particularly low-noise, unobtrusive operation (e.g. bedrooms). The air purifier switches to the lowest fan speed.
  5. When the switch button is pressed again, the air purifier returns to automatic mode (A).
- Note: The air purifier can be switched off by pressing and holding down the switch button. Just press it to switch the device back on.

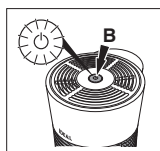

### Air quality indicator

The air quality is displayed in 3 colours (in all fan speeds):

Switch button (B) green:  
Switch button yellow:  
Switch button red:

good air quality  
average air quality  
poor air quality

### Filter replacement indicator

The switch button (B) flashes orange to indicate that the filter needs changing (flashes at intervals).

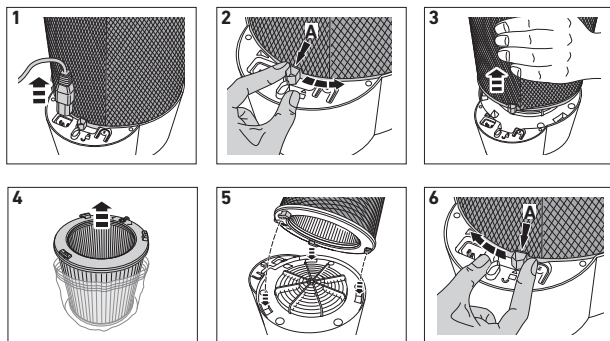

### Filter replacement

**⚠ Take the mains plug out of the socket.**

- Unlock the filter cartridge at the locking component (A) and remove.
  - Remove the protective film from the new filter cartridge.
  - Insert the filter cartridge with the three snap-fit tabs into the three recesses provided for this and lock it at the locking component (A).
  - Connect the power cable to the device first, then to the socket. The device will only work if the filter cartridge is installed correctly.
- Note: The air purifier automatically detects that a new IDEAL filter cartridge has been inserted and automatically resets the filter replacement indicator.

IDEAL filter cartridge - order from  
[www.mbmcorp.com](http://www.mbmcorp.com)

# EN Operation / Notes

## Remote control (only AP40 PRO)

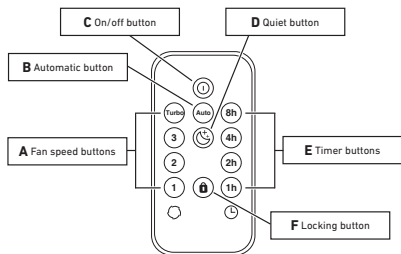

- A:** Select the required fan speed ( ).  
**B:** Switches the air purifier to automatic mode ( ).  
**C:** Switches the air purifier on/off ( ).  
**D:** Switches the air purifier to Quiet mode ( ).  
**E:** Select the required timer time ( ).

Pressing the timer while the air purifier is switched on activates the „switch-off timer“ → after the set time, the air purifier switches off. Pressing the timer button while the air purifier is switched off activates the „switch-on timer“ → after the set time, the air purifier switches on. Visualisation only in the app (smartphone / tablet).

- F:** Press the locking button ( ) to lock the air purifier switch button. Press the locking button again to unlock. It can also be unlocked by disconnecting the air purifier from the mains

### Note:

When the remote control is operated, the switch button on the air purifier lights up white for approx. 1 second in acknowledgement. If you press the air purifier switch button when the locking function is activated, it lights up briefly in red.

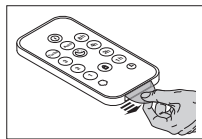

### When using for the first time

The remote control has a pre-installed lithium battery CR2025. **Remove the protective flap** to activate the remote control battery.

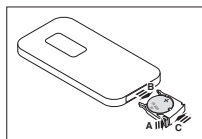

### Replacing the battery

- Open the battery compartment by pressing (A) and pulling out (B) at the same time. Take out the flat battery.
- Insert a new battery into the battery compartment, making sure the polarity is correct (+ / -).
- Always use 3V lithium batteries CR2025.
- Slide the battery compartment back into its seating (C).

### How to use correctly

Point the remote control at the air purifier (switch button B).

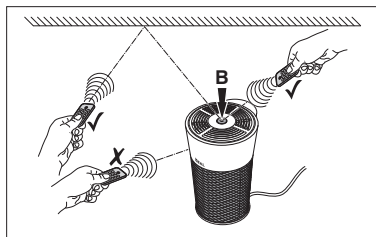

## Important information about the batteries and how to dispose of them

Batteries must NOT be disposed of with household waste. As the user, you are legally obligated to return used batteries for proper disposal. You can hand in your batteries at public collection points in your community or wherever the same type of batteries are sold.

- It is very important that you make sure that the polarity of the batteries is correct. Wrongly inserted batteries could destroy the device – a fire hazard.
- Do not try to open or damage batteries and do not throw batteries into a fire.
- Batteries that are leaking fluid are dangerous. Only touch these with suitable gloves.
- Keep batteries out of the reach of children.
- Take the batteries out of the device if you are not going to be using it for a significant period of time.
- The cells shall be disposed of properly, including keeping them away from children.
- Even used cells may cause injury.

## Disposal

This device must not be disposed of with household waste! Please hand this device in at the collection points provided! Collecting and recycling electrical and electronic waste conserves valuable resources!



The packaging material can be recycled. Dispose of the packaging in an environmentally friendly manner and take it to the recyclable waste collection.

**Thanks!**





EN Technical data

AP30 PRO:

Power supply	200-240V-50/60Hz / 100-120V-50/60Hz
Power consumption	30W (200-240V) / 25W (100-120V)
Suitable for rooms	20 to 40 m² *
Air flow rate (max.)	310 m³/h
Dimensions (L × W × H)	298 × 255 × 398 mm
Weight	3,6 kg
Volume at turbofan speed  (max.)	54,2 dB(A)
Volume in Quiet mode  (min.)	16,7 dB(A)

AP40 PRO:

Power supply	200-240V-50/60Hz / 100-120V-50/60Hz
Power consumption	75W (200-240V) / 55W (100-120V)
Suitable for rooms	30 to 50 m² *
Air flow rate (max.)	440 m³/h
Dimensions (L × W × H)	298 × 255 × 398 mm
Weight	3,6 kg
Volume at turbofan speed  (max.)	61,7 dB(A)
Volume in Quiet mode  (min.)	16,7 dB(A)

Subject to technical changes

\* For a room height of 2.50 m

This machine is approved by independent safety laboratories and is in compliance with the EC-regulations. The exact technical specifications can be found on the technical specifications sticker on the machine. To claim under guarantee, the machine must still carry its original identification label. Subject to alterations without notice.

EC-declaration of conformity

- Herewith we declare that

IDEAL AP30 PRO Made in Germany	GS-IDENT. No. 11731002	UL-IDENT. No. 10731002
IDEAL AP40 PRO Made in Germany	11731001	10731001

- complies with the following provisions applying to it

2014/35/EU Low voltage directive  
2011/65/EU, 2015/863/EU RoHS directive  
2014/30/EG EMV Electromagnetic compatibility directive

- Applied harmonised standards in particular

IEC 61000-3-2; IEC 61000-3-3; EN 61000-3-2; EN 61000-3-3;  
EN 60335-2-65; EN 60335-1;  
EN ISO 13857; EN 55014-1; EN 55014-2;  
BS EN 55014-1; BS EN 55014-2 ;  
BS EN 61000-3-2; BS EN 61000-3-3;  
BS EN 60335-2-65; BS EN 60335-1; BS EN ISO 13857-1

09.02.2022  
Date  
Authorized representative for technical documentation:

  
- Managing Director -  
Krug & Priester GmbH & Co. KG  
Simon-Schweitzer-Str. 34  
D-72336 Balingen (Germany)

Certifications

The company Krug + Priester has the following certifications:

- Quality management system according to DIN EN ISO 9001:2015
- Environmental management system according to DIN EN ISO 14001:2015
- Energy management system according to DIN EN ISO 50001:2018





**Supplier's Declaration of Conformity**  
**47 CFR § 2.1077 Compliance Information**

This device complies with part 15 of the FCC Rules. Operation is subject to the following two conditions:

- (1) This device may not cause harmful interference, and
- (2) this device must accept any interference received, including interference that may cause undesired operation.

**Manufacturer:** KRUG + PRIESTER GMBH & CO KG  
Simon-Schweitzer-Straße 34  
72336 Balingen, Germany

**U.S. Responsible Party:** MBM Corporation  
3134 Industry Drive  
North Charleston SC, 29418  
Tel: 843-552-2700  
Mail: [info@mbmc corp.com](mailto:info@mbmc corp.com)

**Trade Name:** IDEAL

**Models:** AP 30/ 40/ 60/ 80/ 140 PRO

**Classification:** FCC Part 15B

We herby declare, that the equipment bearing tradename and model number specified above was tested conforming to the applicable FCC rule part(s) 15B and the most accurate measurement standards. We confirm that the necessary steps have been taken and are in force to assure that the production units of the same equipment will continue to comply with the Commission's requirements.

Krug + Priester GmbH & Co KG

**NOTE:** This equipment has been tested and found to comply with the limits for a Class B digital device, pursuant to part 15 of the FCC Rules. These limits are designed to provide reasonable protection against harmful interference in a residential installation. This equipment generates, uses and can radiate radio frequency energy and, if not installed and used in accordance with the instructions, may cause harmful interference to radio communications. However, there is no guarantee that interference will not occur in a particular installation. If this equipment does cause harmful interference to radio or television reception, which can be determined by turning the equipment off and on, the user is encouraged to try to correct the interference by one or more of the following measures:

- Reorient or relocate the receiving antenna.
- Increase the separation between the equipment and receiver.
- Connect the equipment into an outlet on a circuit different from that to which the receiver is connected.
- Consult the dealer or an experienced radio/TV technician for help.

To ensure compliance with FCC and ISED RF exposure requirements this device must be installed to provide a minimum of 20cm between the device and people.

## KRUG+PRIESTER

Krug & Priester GmbH & Co. KG  
Simon-Schweitzer-Str. 34  
D-72336 Balingen (Germany)